

LAVO

# EV Charger App User Manual

LAVO



## I Overview

The EV Charger Commissioning Guide by LAVO provides comprehensive instructions for configuring and managing Wi-Fi modules and utilizing the accompanying EV Charger App. This document serves as a detailed resource for technicians and users alike, offering step-by-step guidance on setting up and optimizing the Wi-Fi connection for seamless operation of LAVO's EV charging infrastructure.

By following the instructions outlined in this guide, users can ensure the efficient deployment and operation of LAVO's EV charging solutions, which will facilitate convenient and reliable charging experiences for electric vehicle owners.

## 2 Wi-Fi Module Configuration Network Operational Manual

### 2.1 Open Web Management Interface

There are two web pages available within the modules: an internal webpage and an external webpage dedicated to web management.

#### How to Connect the Server

1. Connect your device to the SSID "PILExxxxxxxx" using your wireless LAN card. "xxxxxxxxxxxx" is the unique identifier for this charger.
2. Once the wireless connection is established, open your web browser, and navigate to "http://10.10.100.254".
3. Input the username and password on the subsequent page, then click the "OK" button. The username is "admin", and the password remains the same.



### 2.2 System Page

This page allows the user to view the current device's vital information and status, including the Device ID (MID), software version, wireless operating mode, and relevant Wi-Fi parameters.

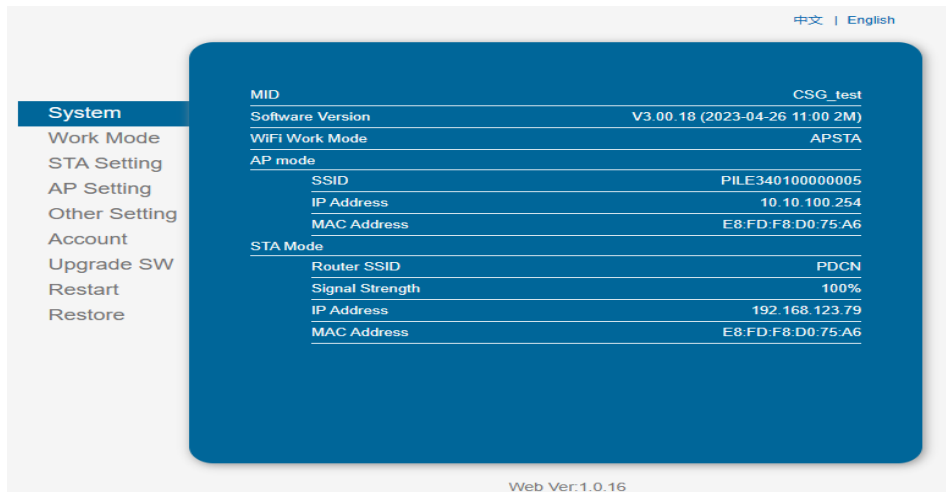

### 2.3 Work Mode Page

The Wi-Fi module offers the flexibility to operate in AP mode, simplifying user configuration, and can also function in STA mode to connect to a remote server through the AP router. We've chosen the "AP+STA mode" for operation.

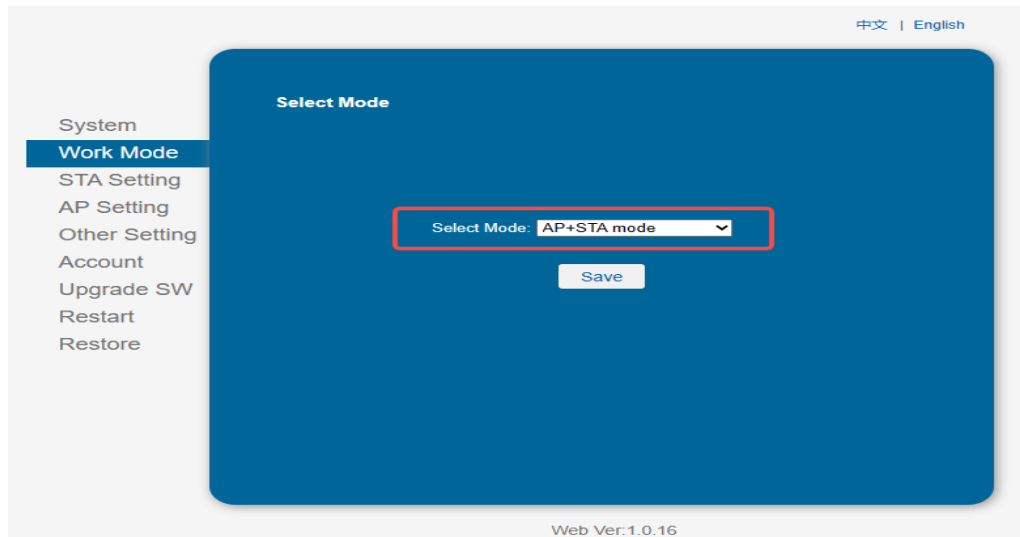

### 2.4 STA Setting Page

Please select the "Scan" button to auto-search the Wi-Fi AP routers nearby, and you can connect with the associate AP through some settings. Please note the encryption information input here must be entirely the same as the Wi-Fi AP router's configuration, and then it can link with AP correctly.

Note: Please refrain from restarting at this time; proceed to the next step instead.

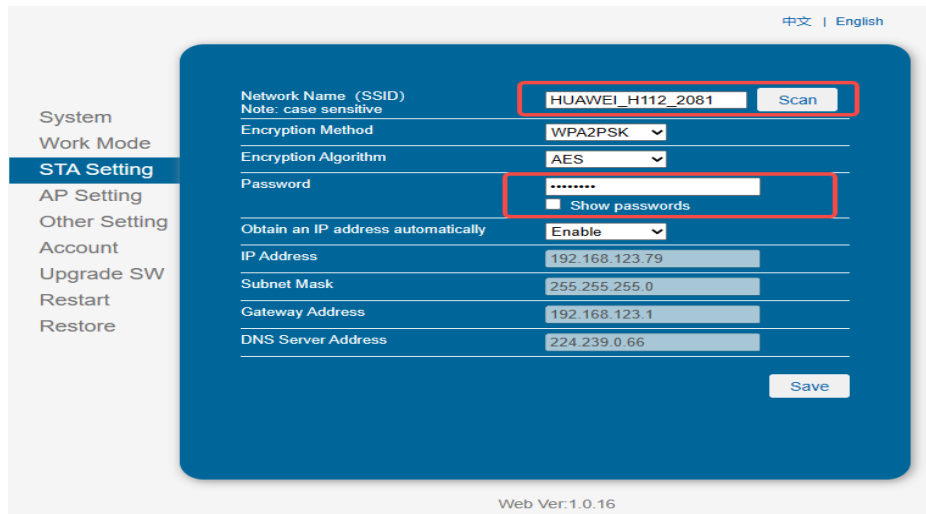

Figure STA Setting Page

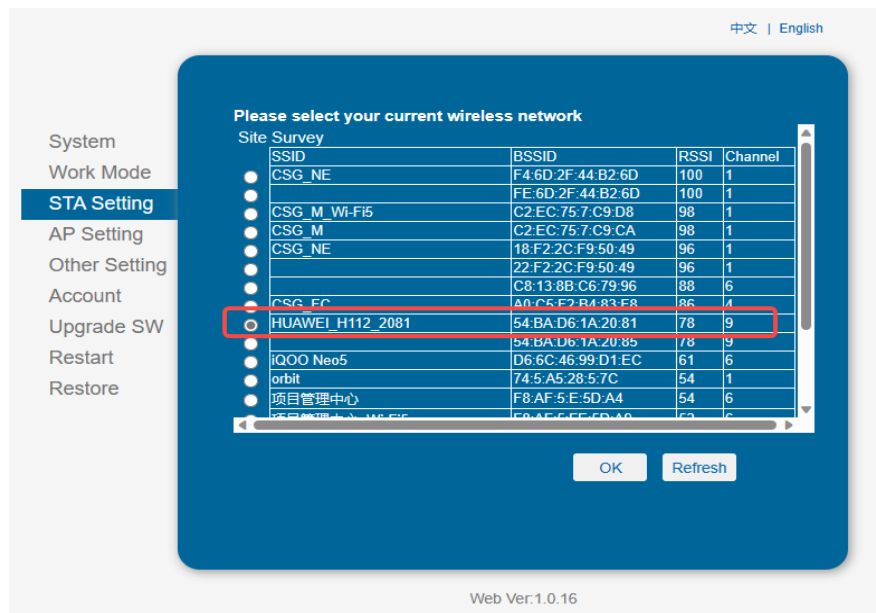
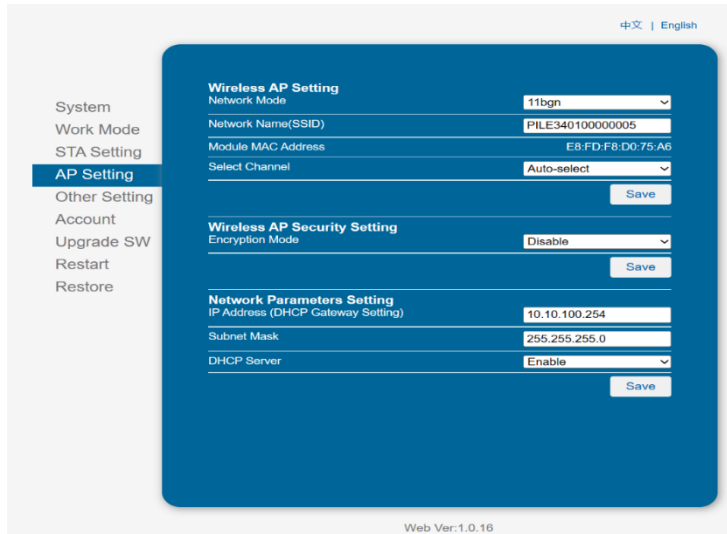

Figure STA Scan Page

## 2.5 AP Setting Page

When the user selects a module that works in AP+STA mode, this page must be set, and wireless and network parameters must be provided. Most systems support DHCP in achieving an IP address, so we suggest "Enabling" the DHCP server in most applications.

Note: Please refrain from restarting at this time; proceed to the next step instead.



## 2.6 Other Setting Page

“PILExxxxxxxxx” usually works in data transparent transmission mode. In this mode, the device connects and communicates with a remote server as a client. On this page, the user needs to set serial port communication parameters and define TCP-related protocol parameters.

Note: Please refrain from restarting at this time; proceed to the next step instead.

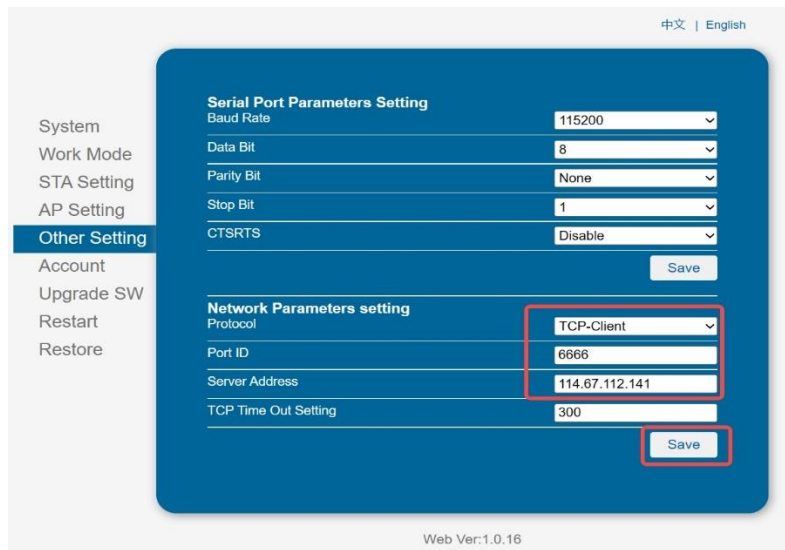

## 2.7 Restart Page

Many of the settings and configurations require a system restart to take effect. Users should restart the system after completing all settings adjustments.

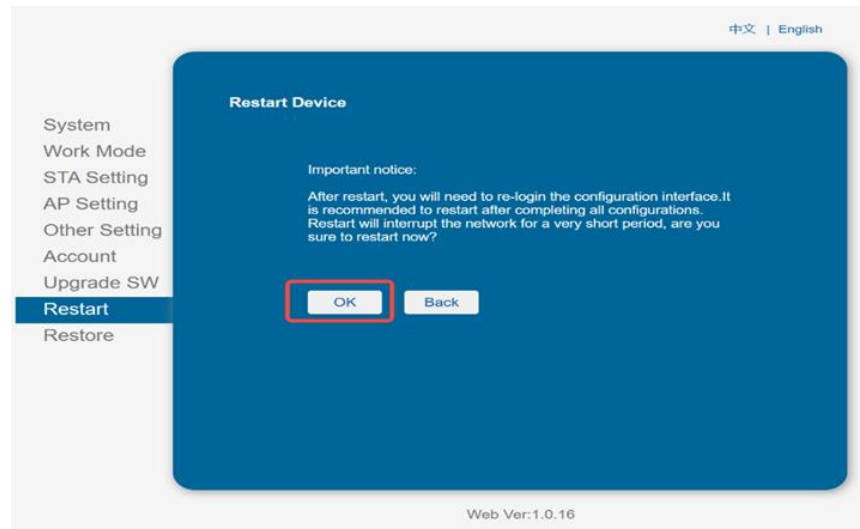

## 3 EV Charger App User Manual

### 3.1 Log in to Customer's Account

Launch the application. If you already have an account, you can log in directly. If you don't have an account, click the "No account?" button to sign up and log in.

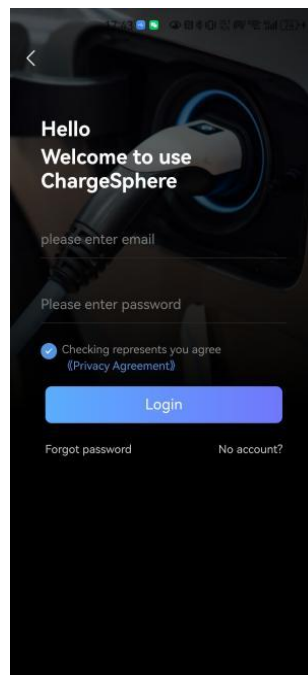

### 3.2 Bind the Charger App

Press the "Bind Device" button to link to the EV Charger. You have the option to scan the QR code on the EV Charger or click "Enter manually" to input the charger code directly.

